

Cheetah HC 72M

395-415 Watt

MONO PERC HALF CELL MODULE

Positive power tolerance of 0~+3%

- Half Cell
- Mono PERC 72 Cell



PERC



KEY FEATURES



5 Busbar Solar Cell

5 busbar solar cell adopts new technology to improve the efficiency of modules, offers a better aesthetic appearance, making it perfect for rooftop installation.



High Efficiency

Higher module conversion efficiency (up to 20.63%) benefit from half cell structure (low resistance characteristic).



PID Resistance

Excellent Anti-PID performance guarantee limited power degradation for mass production.



Low-light Performance

Advanced glass and cell surface textured design ensure excellent performance in low-light environment.



Severe Weather Resilience

Certified to withstand: wind load (2400 Pascal) and snow load (5400 Pascal).



Durability Against Extreme Environmental Conditions

High salt mist and ammonia resistance certified by TUV NORD.

LINEAR PERFORMANCE WARRANTY

12 Year Product Warranty • 25 Year Linear Power Warranty



- ISO9001:2015, ISO14001:2015, ISO45001:2018 certified factory
- IEC61215(2016), IEC61730(2016) certified product

Nomenclature:

JKMxxxM-60/72H-V

Code	Cell	Code	Certification
null	Full	null	1000V
H	Half	V	1500V

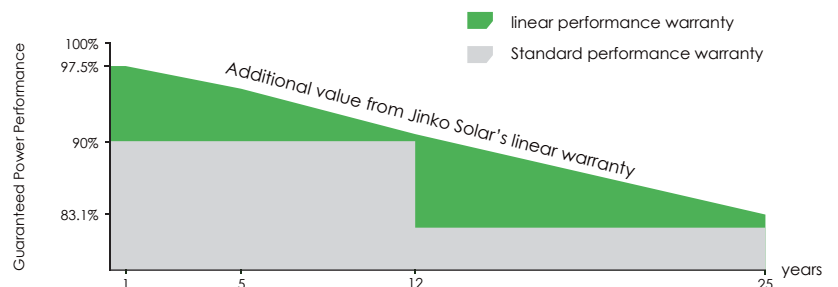

Engineering Drawings

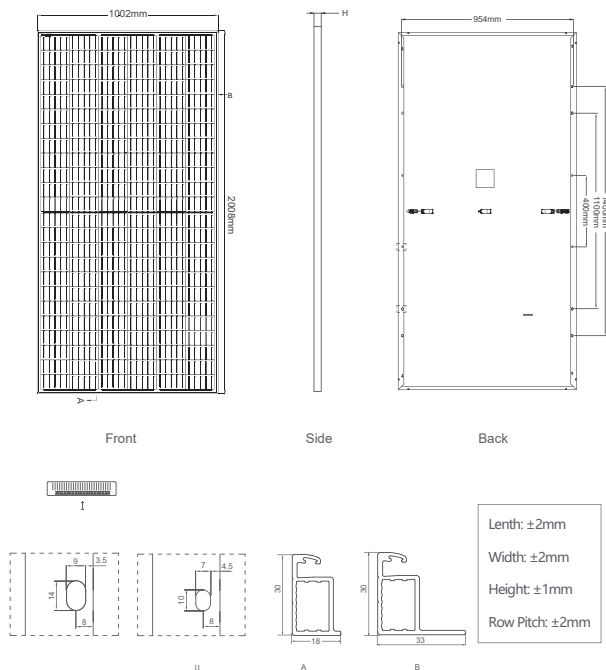

Packaging Configuration

(Two pallets = One stack)

35pcs/pallet, 70pcs/stack, 770pcs/40'HQ Container

Electrical Performance & Temperature Dependence

Current-Voltage & Power-Voltage Curves (410W)

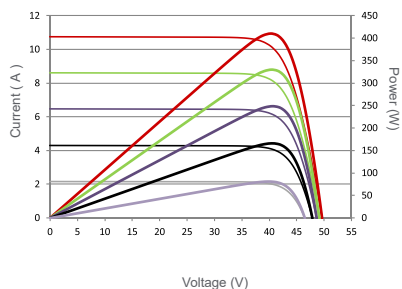

Temperature Dependence of Isc, Voc, Pmax

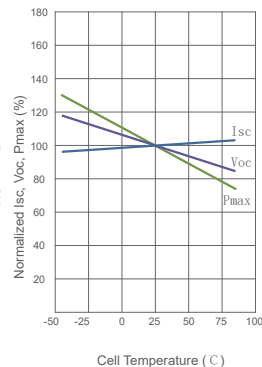

Mechanical Characteristics

Cell Type	Mono PERC 158.75×158.75mm
No. of Half-cells	144 (6×24)
Dimensions	2008×1002×30mm (79.06×39.45×1.18 inch)
Weight	22.0 kg (48.5 lbs)
Front Glass	3.2mm, Anti-Reflection Coating, High Transmission, Low Iron, Tempered Glass
Frame	Anodized Aluminium Alloy
Junction Box	IP67 Rated
Output Cables	TÜV 1x4.0mm ² , (+) 290mm, (-) 145mm or Customized Length

SPECIFICATIONS

Module Type	JKM395M-72H		JKM400M-72H		JKM405M-72H		JKM410M-72H		JKM415M-72H		
	JKM395M-72H-V	JKM400M-72H-V	JKM405M-72H-V	JKM410M-72H-V	JKM415M-72H-V	STC	NOCT	STC	NOCT	STC	NOCT
Maximum Power (Pmax)	395Wp	291Wp	400Wp	294Wp	405Wp	298Wp	410Wp	302Wp	415Wp	305Wp	
Maximum Power Voltage (Vmp)	39.9V	37.4V	40.16V	37.6V	40.42V	37.8V	40.68V	38.0V	40.93V	38.2V	
Maximum Power Current (Imp)	9.90A	7.77A	9.96A	7.82A	10.02A	7.88A	10.08A	7.94A	10.14A	8.00A	
Open-circuit Voltage (Voc)	48.80V	46.0V	49.10V	46.2V	49.4V	46.5V	49.6V	46.7V	49.90V	47.0V	
Short-circuit Current (Isc)	10.54A	8.51A	10.61A	8.57A	10.69A	8.63A	10.76A	8.69A	10.82A	8.74A	
Module Efficiency STC (%)	19.63%		19.88%		20.13%		20.38%		20.63%		
Operating Temperature (°C)	-40°C~+85°C										
Maximum System Voltage	1000/1500VDC (IEC)										
Maximum Series Fuse Rating	20A										
Power Tolerance	0~+3%										
Temperature Coefficients of Pmax	-0.35%/°C										
Temperature Coefficients of Voc	-0.29%/°C										
Temperature Coefficients of Isc	0.048%/°C										
Nominal Operating Cell Temperature (NOCT)	45±2°C										

STC: Irradiance 1000W/m² Cell Temperature 25°C AM=1.5

NOCT: Irradiance 800W/m² Ambient Temperature 20°C AM=1.5 Wind Speed 1m/s

* Power measurement tolerance: $\pm 3\%$